

EL-10461

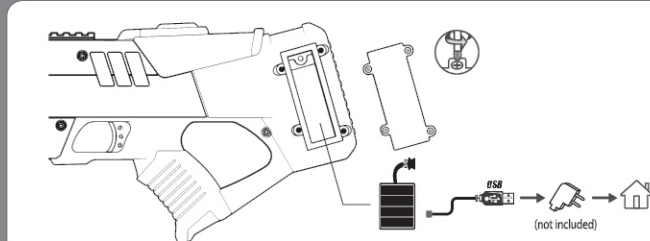

Silverlit® Silverlit SAS, 80 rue Barthelemy Denjoux, 92100 Boulogne-Billancourt / France. ©2024 Silverlit. All rights reserved.

Battery Installation



Parts Identification

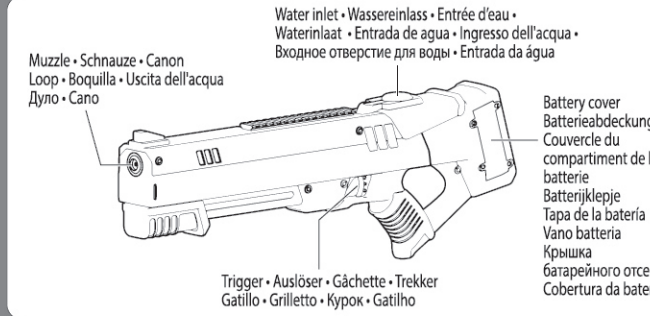

How to Play

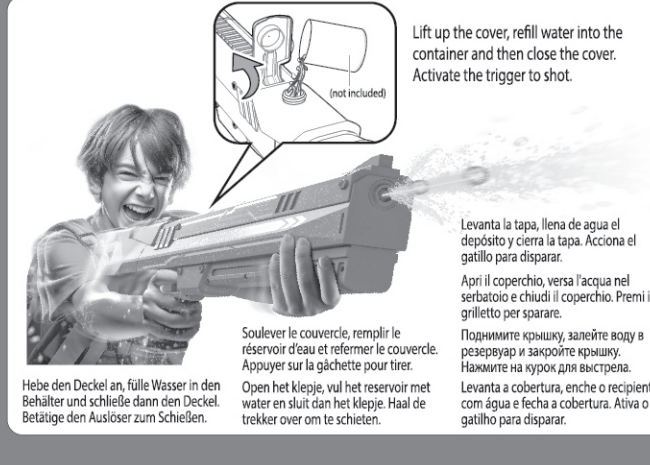

ENGLISH

This product complies with the 2009/48/EC standard. Instruction sheet and packaging must be retained since it contains important information. Waste electrical and electronic equipment (WEEE)...

DEUTSCH

Dieses Produkt erfüllt die Norm 2009/48/CE. Anleitung und Verpackung müssen aufbewahrt werden, da sie wichtige Informationen enthalten. Elektrische und elektronische Abfälle...

FRANÇAIS

Ce produit est conforme à la norme 2009/48/CE. Conservez le mode d'emploi et l'emballage car ils contiennent des informations importantes. Déchets électriques et électroniques (DEEE)...

NEDERLANDS

Dit product voldoet aan norm 2009/48/CE. Bewaar de gebruiksaanwijzing en de verpakking, deze bevatten belangrijke informatie. Elektrische en elektronische afval (WEEE)...

SPANISH

Este producto se ajusta a la norma 2009/48/CE. Conserve la hoja de instrucciones y el envase, ya que contienen información importante. Desechos eléctricos y electrónicos (DEEE)...

ITALIAN

Questo prodotto è conforme alla norma 2009/48/CE. Conservare le istruzioni e la confezione perché contengono informazioni importanti. Rifiuti elettrici ed elettronici (REE)...

RUSSIAN

Данное изделие соответствует стандарту 2009/48/CE. Сохраните инструкцию и упаковку, так как они содержат важную информацию. Игрушку можно подходить только в образовательных целях...

PORTUGUÊS

Este produto está em conformidade com a norma 2009/48/CE. A folha de instruções e embalagem devem ser guardadas, uma vez que contém informações importantes. Resíduos de equipamentos eléctricos e electrónicos (REEE)...