

3. Flight control:

Hover up and down:

When the helicopter flies steadily, you can slowly push the throttle stick up to make helicopter fly higher, or lower the stick a bit to make helicopter fly lower. Only small amounts of stick position change are required for smooth flying. (fig.7 & fig.8)

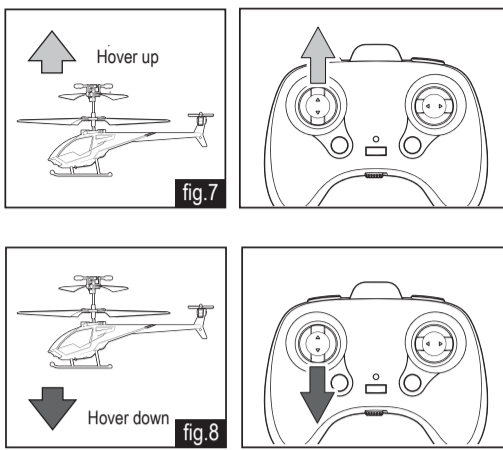

Turn left and right:

Maintain the helicopter at a certain height. Push the direction stick toward left to turn counter clockwise (fig.9), and push the direction stick toward right to turn clockwise. (fig.10)

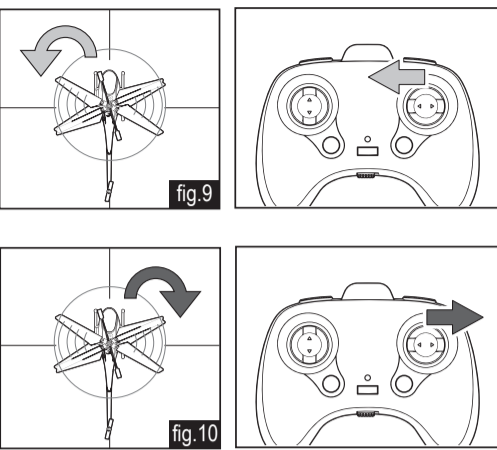

4. Lift-off Procedures (after trimming procedure):

- Put the helicopter on a smooth surface. Uneven floor surface will affect its lifting off.
- Slowly increase the throttle.
- DO NOT look at the transmitter but focus on the helicopter.
- As soon as the helicopter leaves ground, reduce the throttle slightly. (in the worst case, helicopter will go back to the floor, but that is better than crashing against the ceiling)
- VERY gently add the throttle if the helicopter goes down.
- VERY gently reduce the throttle if the helicopter goes up.
- For turning, give short and small inputs to the direction stick. (most beginners will easily overcontrol the helicopter)

5. HELICOPTER HEADLIGHT:

- Switch on the helicopter the headlight will light up automatically.

Trouble Shooting

Symptom	Cause	Correction
The helicopter does not response.	- The helicopter and/ or the transmitter is switch off ("OFF"). - The battery of the helicopter is weak.	- Set the power switch to "ON". - Recharge the battery of the helicopter.
Suddenly stop and drop down when flying.	- The battery of the helicopter is weak.	- Recharge the battery of the helicopter.
Loss of control.	- Another infrared control device using the same frequency band. - Affected by strong lighting.	- Point the transmitter to the helicopter. - Change another environment to avoid direct lighting.

Air Mamba™

Become our fan on facebook
facebook.com/SilverlitToys

Visit us at
www.Silverlit.com

Part Identification

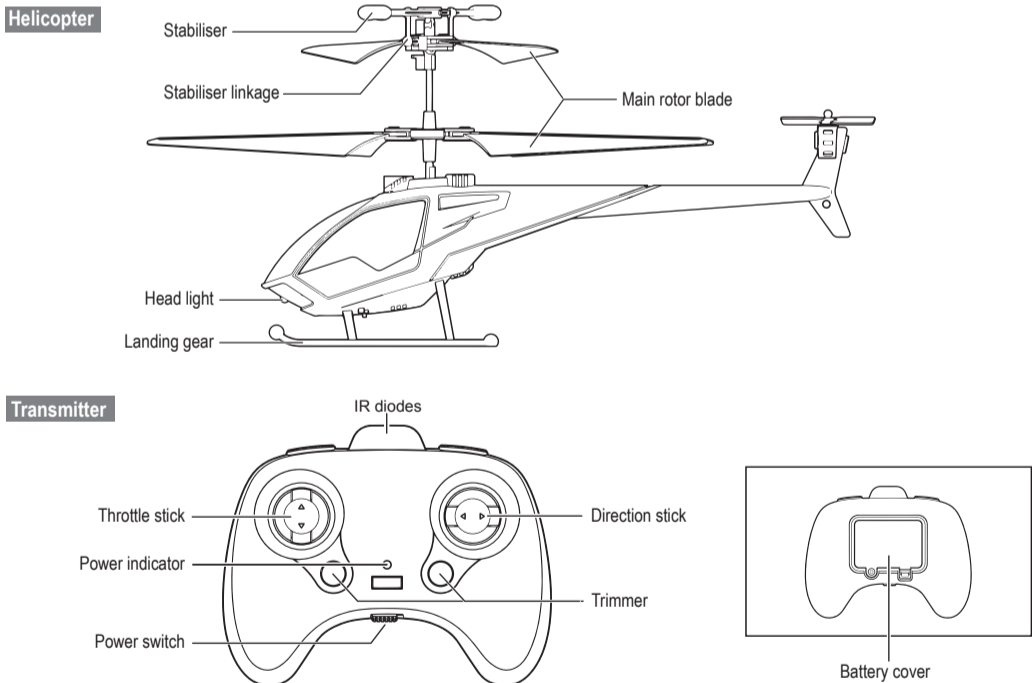

Battery Installation & Charging

Transmitter Battery Installation (*Make sure the power switch is on "OFF" position.)

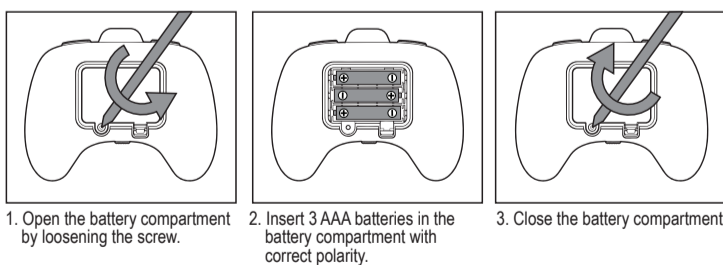

Warning!

Remove these batteries from the unit by pulling up on one end of each battery positive by hand.

DO NOT remove or install batteries using sharp or metal tools.

Charging Helicopter

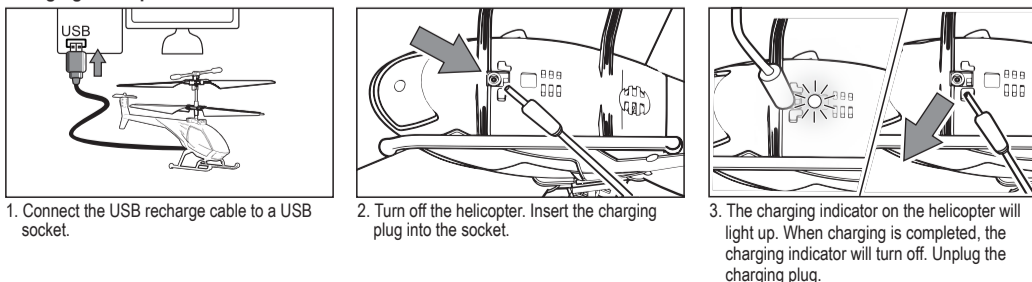

Note: 1. The helicopter can operate for about 5 - 6 minutes per every 25 - 40 minutes charging.
2. Before recharging the battery, wait 10 - 15 minutes for it to cool down.

AIR MAMBA



For ages 8+ • Ab 8 Jahre
A partir de 8 ans • Leeftijd vanaf 8 jaar
A partir de 8 años • Dai 8 anni in su
Для детей от 8 лет • Para idades superiores a 8 anos

This toy is only to be connected to equipment bearing either of the following symbols:

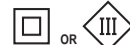

Delivery contents



Precautions, Warnings & Statements

The crossed-out dustbin symbol indicates that batteries, rechargeable batteries, button cells, battery packs, etc. must not be put in the household waste. Batteries are harmful to health and the environment. Please help to protect the environment from health risks. If the toy is out of use, please use common household tool to break the product for built-in rechargeable battery operated toy or unscrew the battery door for replaceable battery operated toy, then take the battery out from the toy. Dispose of battery in accordance with your local battery recycling or disposal laws.

WEEE
When this appliance is out of use, please remove all batteries and dispose of them separately. Bring electrical appliances to the local collecting points for waste electrical and electronic equipment. Other components can be disposed of in domestic refuse.

Safety precautions:
Warning: Changes or modifications to this unit not expressly approved by the party responsible for compliance could void the user's authority to operate the equipment.
- The USB cable is tailor-made for charging the LiPo battery in the helicopter. Do not use it to charge any other batteries.

FCC Statements
This device complies with part 15 of the FCC rules. Operation is subject to the following two conditions:
1) This device may not cause harmful interference, and
2) This device must accept any interference received, including interference that may cause undesired operation.
NOTE: This equipment has been tested and found to comply with the limits for a Class B digital device, pursuant to Part 15 of the FCC Rules.
These limits are designed to provide reasonable protection against harmful interference in a residential installation. This equipment generates, uses and can radiate radio frequency energy and, if not installed and used in accordance with the instructions, may cause harmful interference to radio communications. However, there is no guarantee that interference will not occur in a particular installation. If this equipment does cause harmful interference to radio or television reception, which can be determined by turning the equipment off and on, the user is encouraged to try to correct the interference by one or more of the following measures:
- Reorient or relocate the receiving antenna.
- Increase the separation between the equipment and receiver.
- Connect the equipment into an outlet on a circuit different from that to which the receiver is connected.
- Consult the dealer or an experienced radio/TV technician for help.

USB cable statement:
- If battery cannot be charged. Please try another adapter.
- The product must only be used with the provided USB cable for charging.
- Do not use high output adapter for battery charging (1A or above).
- Transformer or battery charger used with the toy are to be regularly examined for damage to the cord, plug, enclosure and other parts, and in the event of such damage, they must not be used until the damage has been repaired.

Special notes to adults:
- Before first use: read the user's information together with your child.
- This toy is intended to be used in domestic area (house and garden) only.
- Do not change or modify anything on the helicopter!
- Assembly should be performed under adult supervision (changing batteries/ spare parts, trimming etc).
- Parental guidance is recommended when installing or replacing batteries.

Battery warnings:
- Non-rechargeable batteries are not to be recharged.
- Rechargeable batteries are to be removed before being charged. (Transmitter only)
- Rechargeable batteries should be charged under adult supervision.
- Different types of batteries or new and used batteries are not to be mixed. (Transmitter only)
- Only batteries of the same or equivalent type as recommended are to be used.
- Batteries are to be inserted with correct polarity. (+ and -)
- Exhausted batteries are to be removed from the toy. (Transmitter only)
- The supply terminals are not to be short-circuited.
- Do not mix old and new batteries. (Transmitter only)
- Do not mix alkaline batteries, standard batteries (carbon-zinc) and rechargeable batteries (nickel-cadmium). (Transmitter only)

This toy is equipped with a LiPo rechargeable battery, please pay attention to the following cautions for safety use:
- Do not dispose the battery in fire or heat.
- Do not use or leave the battery near a heat source such as fire or heater.
- Do not strike or throw the battery against hard surface.
- Do not immerse the battery in water, and keep the battery in a cool dry environment.
- When recharging, only use the battery charger specifically for that purpose.
- Do not over-discharge the battery.
- Do not connect the battery to an electrical outlet.
- Do not directly solder the battery and pierce the battery with a nail or other sharp object.
- Do not transport or store the battery together with metal objects such as necklaces, hairpins etc.
- Do not disassemble or alter the battery.
- Charge the battery every 6 months.
- This toy (helicopter) contains battery that is non-replaceable

Tip! SAFETY
- Never take apart or attempt to modify the product. This could damage the product.
- Flying the helicopter requires skill and children must be trained under the direct supervision of an adult.
- Never operate this product if it has damaged parts.
- This product is designed for indoor use only. Wind and short transmission range can lead to loss of control.
- Caution: Do not start up and fly when persons, animals or any obstructions are within the flying range of the helicopter.
- Do not fly the helicopter in the vicinity of water and power lines.
- For safe use, the room where the toy is used must be sufficiently large.
- Stand during operation in order to get out of the way of the helicopter quickly if necessary.
- Always keep your eyes on the helicopter and prevent it from landing or crashing near your head, your body, or on other people.
- Always switch the helicopter and the transmitter off when not operating.
- Warning! Do not touch the running rotors. Keep hands, hair and loose clothes away from moving parts to avoid injury.
- Do not throw or hold any objects in the rotating rotor.
- Caution: Risk of eye injuries! Do not fly near your face to avoid injuries.
- Instruction sheet and packaging must be retained since it contains important information.

Care and Maintenance:
- Always remove batteries from the toy when it is not being used for a long period of time. (Transmitter only)
- Wipe the toy gently with a clean damp cloth.
- Keep the toy away from direct heat.
- Do not submerge the toy into water that can damage the electronic assemblies.

The normal function of the product may be disturbed by Strong Electro Magnetic Interference. If so, simply reset the product to resume normal operation by following the instruction manual. In case the function could not resume, please use the product in other location.

Notes:
- Use new alkaline batteries in this toy to obtain best performance.
- Do not operate battery charger if it has been damaged in anyway.
- This toy must only be used with the recommended charger.

Battery requirement for Transmitter:
Power Supply :
Rating : DC 4.5V, 0.5W
Batteries : 3 x 1.5 V "AAA"/LR03/AM4 (not included)

Battery requirement for Helicopter:
Power Supply :
Rating : DC 3.7 V, 5.2 W
Batteries : 1 x 3.7 V LiPo Rechargeable Battery Pack (included)

Silverlit®

Silverlit SAS, 80 rue Barthelemy Danjou, 92100 Boulogne-Billancourt / France
©2023 Silverlit. All rights reserved.

Flying Your Helicopter

Tip! CONTROLLING

- For controlling the sticks on transmitter, try not to push the sticks immediately any extreme positions. It should be like steering a bicycle rather than pressing computer game sticks.
- For the novice pilot (after the trimming procedure is completed), it is highly recommended to focus exclusively on learning to control the Throttle stick first. If the helicopter turns around by itself there is no need to keep it straight. For the first flight, it is important to learn to keep the helicopter at a constant altitude of around 1 meter with very gentle inputs on the throttle stick. Once the Pilot masters this, he may start learning to take control with the direction stick.

Tip! OPERATION

- After you crash your helicopter, you need to restart the helicopter by slide it's ON/OFF switch to "OFF" and then check for damages. If there is no damage slide the ON/OFF switch to "ON" again.
- Don't operate the helicopter under the direct bright light it will affect the control system of your helicopter.
- Don't cover the IR Diode of the transmitter as it will block the IR signal.
- Don't stick any other label onto the helicopter as it will affect receiving of IR signal.

- Switch on both helicopter and transmitter.
- Place the helicopter on the ground with the tail point towards you and the nose pointing away.

1. Environment for flight:

- Choose the place which meet the following condition:
1. Indoor environment with calm air condition. Beware of the air circulation from the air-conditioner.
 2. Safety area: It is highly recommended that there is no electric fan, air-conditioner, reading lamp or other dangerous objects to flying.

2. Trimming the helicopter:

- Gently push the throttle up to raise your helicopter about 0.5 to 1 meter high.

- When the helicopter spirals (fig.1) or keeps turning clockwise (fig.2), turn the yaw-trim dial to the left until the helicopter flies straight (fig.3).

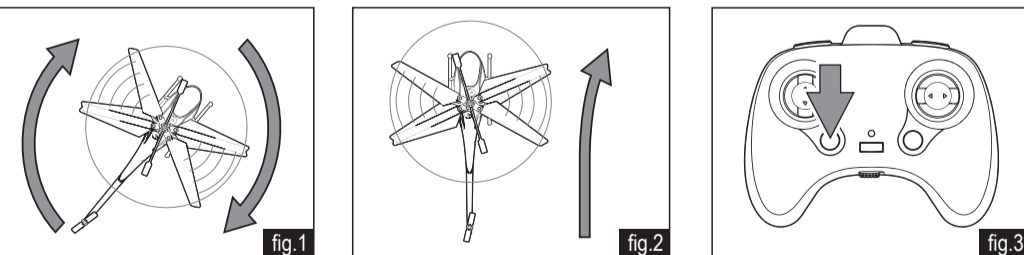

- When the helicopter spirals (fig.4) or keeps turning anticlockwise (fig.5), turn the yaw-trim dial to the right until the helicopter flies straight (fig.6).

