



YOUR EQUIPMENT

(what's included)

Parts x 23 • Life pod x 1 • Astronaut x 1
Achievement card x 1



EUROPA



TYPE:
MOON



SATELLITE OF:
JUPITER



DIAMETER:
3,100 KM



ATMOSPHERE:
MOSTLY OXYGEN



TEMPERATURE:
-160 °C



CHANCE OF LIFE:
POSSIBLE

ASTROPOD™ is an international corporation striving to explore our solar system. This time, they have landed on a moon of Jupiter called EUROPA.

EUROPA was discovered by Galileo in 1610, researched by mankind in 2024, now explored by you.



MISSION: ROVER

EUROPA diameter is 3,100 km, which is **23% the size of EARTH** and its surface is mostly made of water and ice. We must explore this place! Your mission is to build a rover vehicle to explore EUROPA. Remember to develop both **ELECTRIC** and **SOLAR** power to maximise efficiency!



OBJECTIVE:

- 1) Build a Rover Explorer
- 2) Use **ELECTRIC POWER** to move Rover Explorer
- 3) Use **SOLAR POWER** to move Rover Explorer

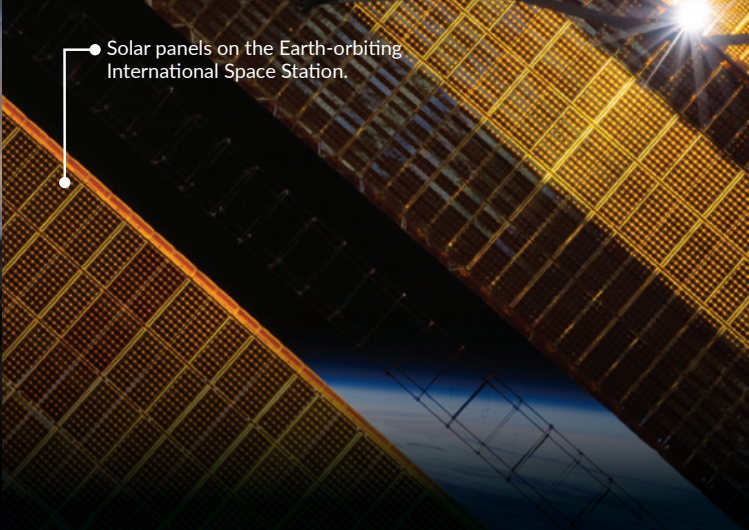

● Solar panels on the Earth-orbiting International Space Station.

DID YOU KNOW?

Solar power is a clean renewable energy and is often used on space exploration. As of 2021, approximately **85% of all space vehicles** were equipped with solar panels and rechargeable batteries, including International Space Station.



Scan for more online instructions
Scannen für weitere Online-Anleitungen
Scannez pour obtenir plus d'instructions en ligne
Scan voor meer online instructies
Escanear para obtener más instrucciones online
Scansiona il codice per ulteriori istruzioni online
Сканируйте, чтобы открыть подробную онлайн-инструкцию
Faz a leitura para obteres mais instruções online

FIND OUT MORE

ASTROPOD™ STORY

HOW TO BUILD

1

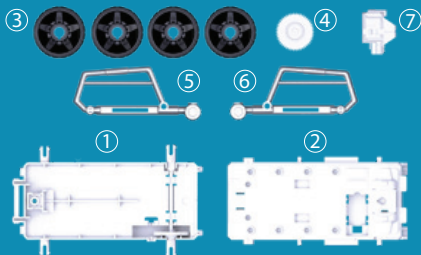

1A

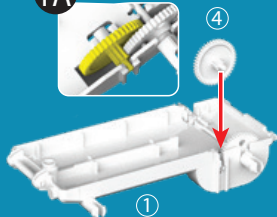

1B

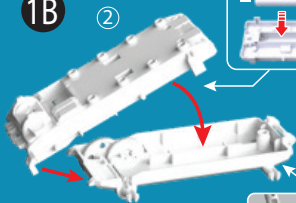

1 X "AAA" not included



2

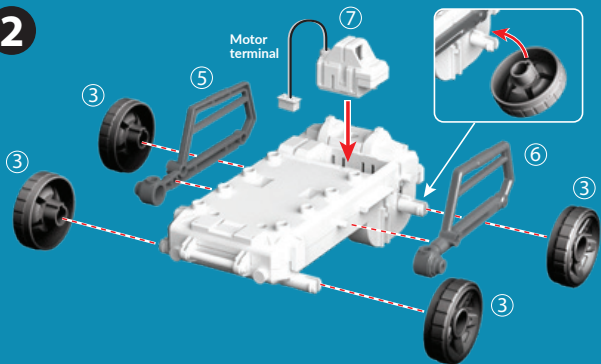

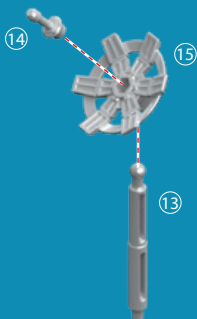
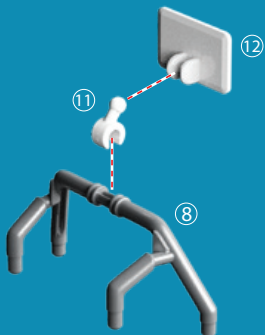
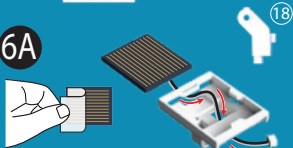
3**4****5****6****6A**

Solar panel terminal

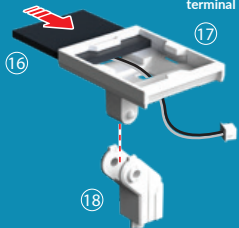
6B

7

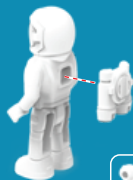
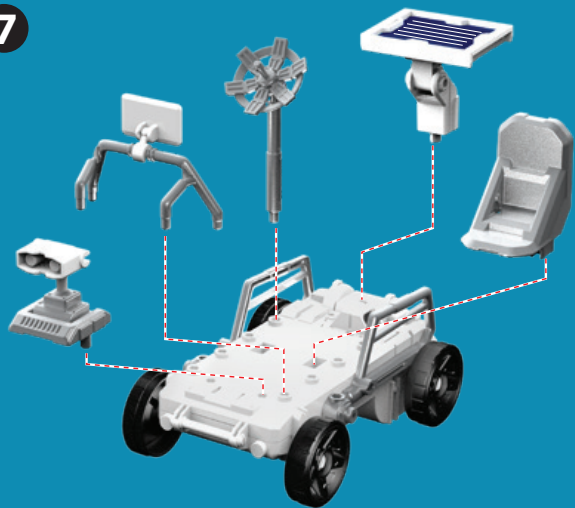

OR

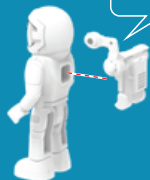

HOW TO PLAY

8

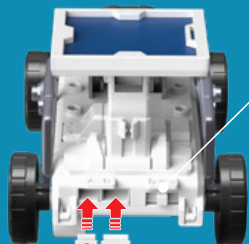

Solar panel terminal

Motor terminal

2 WAYS
TO MOVE ROVER



ELECTRIC
POWER

SOLAR
POWER

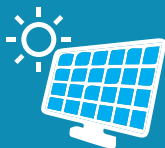

Label Instruction

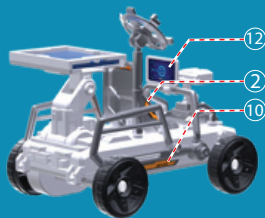

12

2

10



4

11

5

3

6

8

1

7

9

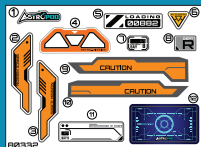

80332