



YOUR EQUIPMENT

(what's included)

Parts x 31 • Life pod x 1 • Astronaut x 1

Achievement card x 1



EUROPA



TYPE:
MOON



SATELLITE OF:
JUPITER



DIAMETER:
3,100 KM



ATMOSPHERE:
MOSTLY OXYGEN



TEMPERATURE:
-160 °C



CHANCE OF LIFE:
POSSIBLE

ASTROPOD™ is an international corporation striving to explore our solar system. This time, they have landed on a moon of Jupiter called EUROPA.

EUROPA was discovered by Galileo in 1610, researched by mankind in 2024, now explored by you.



MISSION: STATION BUILDER

ASTROPOD™ life-supporting **POD** can provide communication system, scientific equipment, and entertainments to our crew. Your mission is to design and build a space station here on EUROPA. Remember, **if the POD connects, it works!**



OBJECTIVE:

- 1) Design and Build a space station.
- 2) Extend the research station by using 2 more pods or rocket parts (extra pods and rocket sold separately)



● Concept art of water vapor ejected off the surface of Europa

DID YOU KNOW?

Jupiter exerts a large gravitational pull to EUROPA, which is **1,000 times** stronger than our tidal force on Earth. This gravitational pull could cause **water vapour erupting** 20km high into the atmosphere!

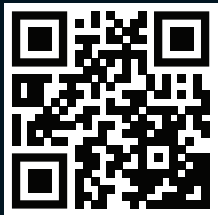

Scan for more online instructions
Scannen für weitere Online-Anleitungen
Scannez pour obtenir plus d'instructions en ligne
Scan voor meer online instructies
Escanear para obtener más instrucciones online
Scansiona il codice per ulteriori istruzioni online
Сканируйте, чтобы открыть подробную онлайн-инструкцию
Faz a leitura para obteres mais instruções online

FIND OUT MORE

ASTROPOD™ STORY

HOW TO BUILD

1

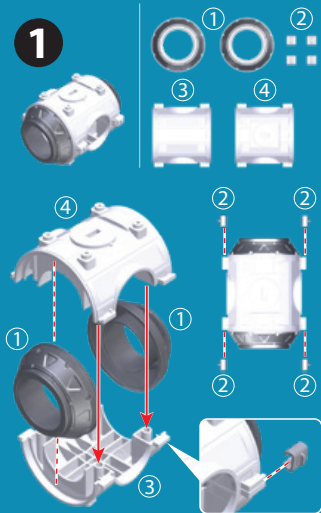

2

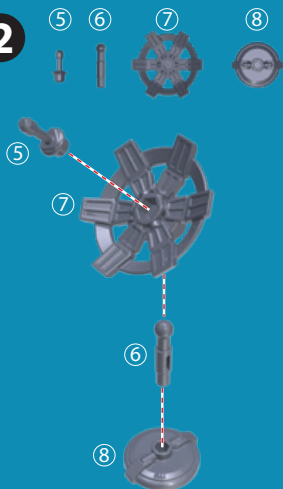

3

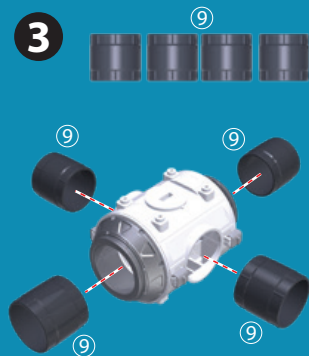

4



5

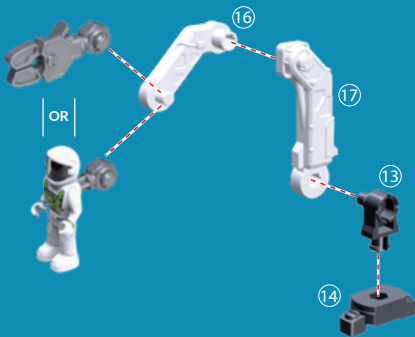
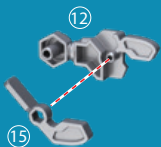
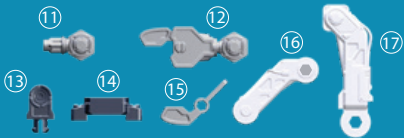

6

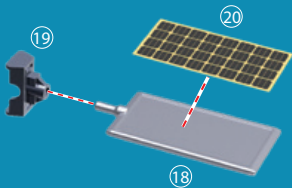
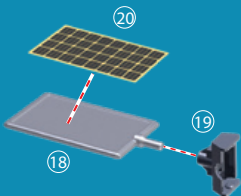

7

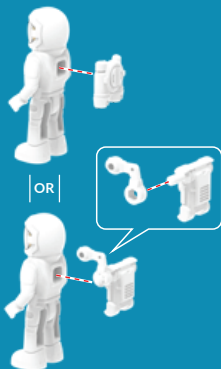

8

